

**NOTES:**  
 - Enclosure to be powder coated RAL6013  
 - All side vents to have insect screen  
 - Bottom of enclosure to have (6) weep holes  
 - Fog/Hazer output holes approximated and will require shop placement

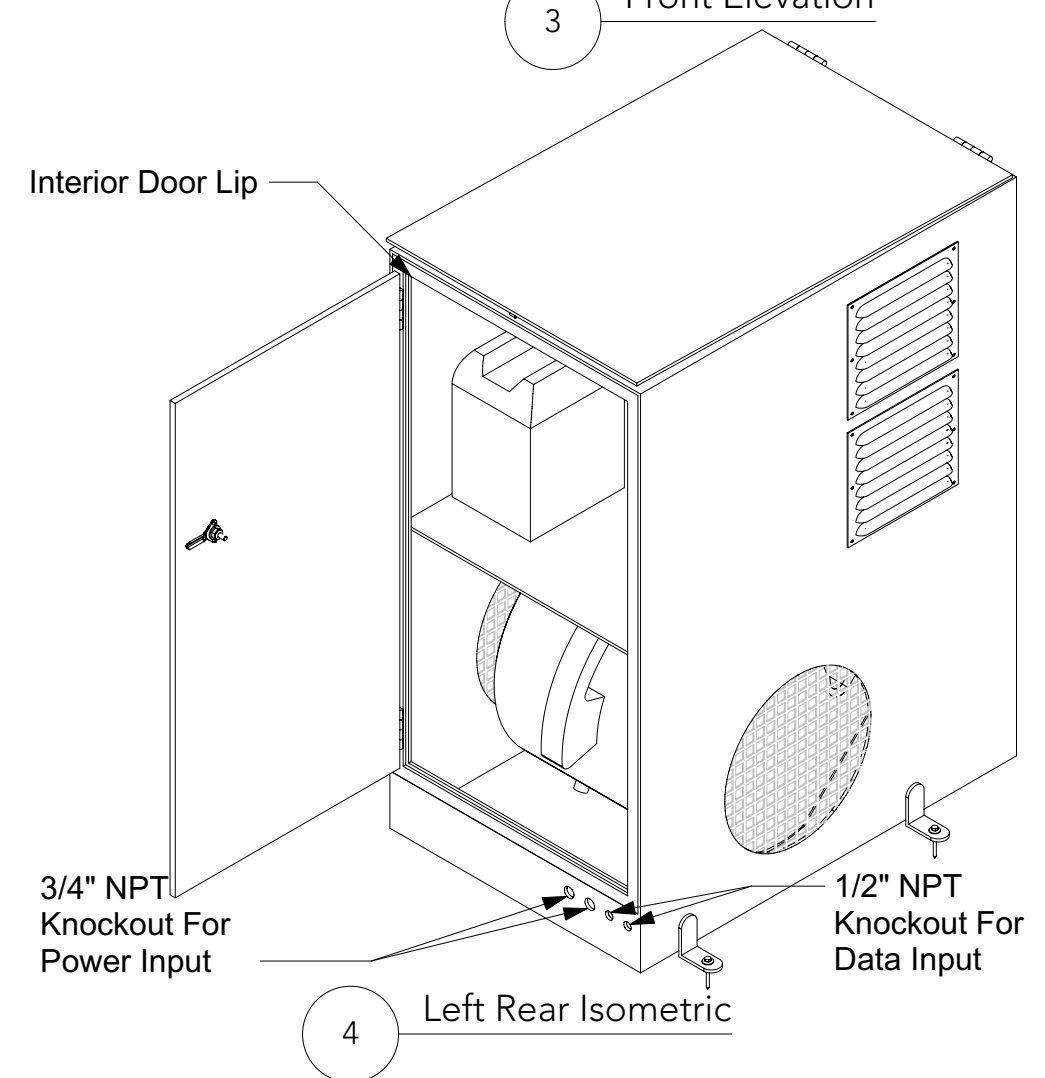
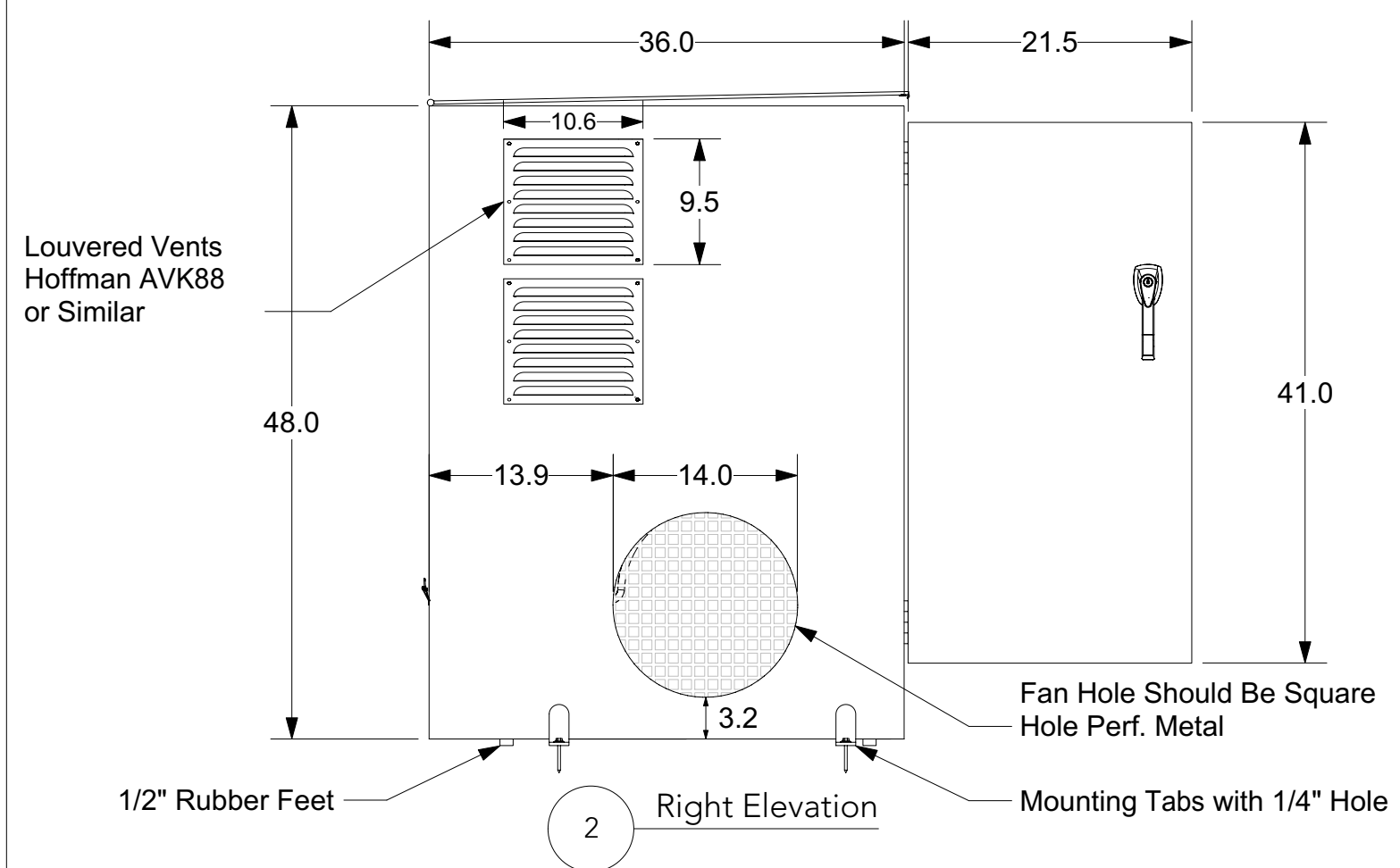
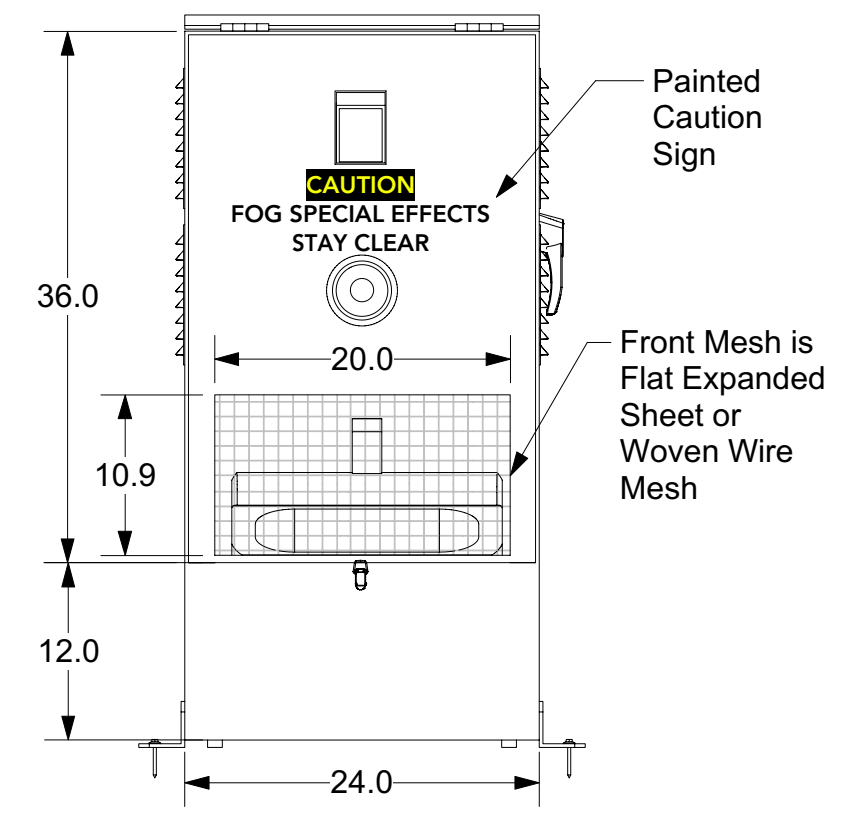
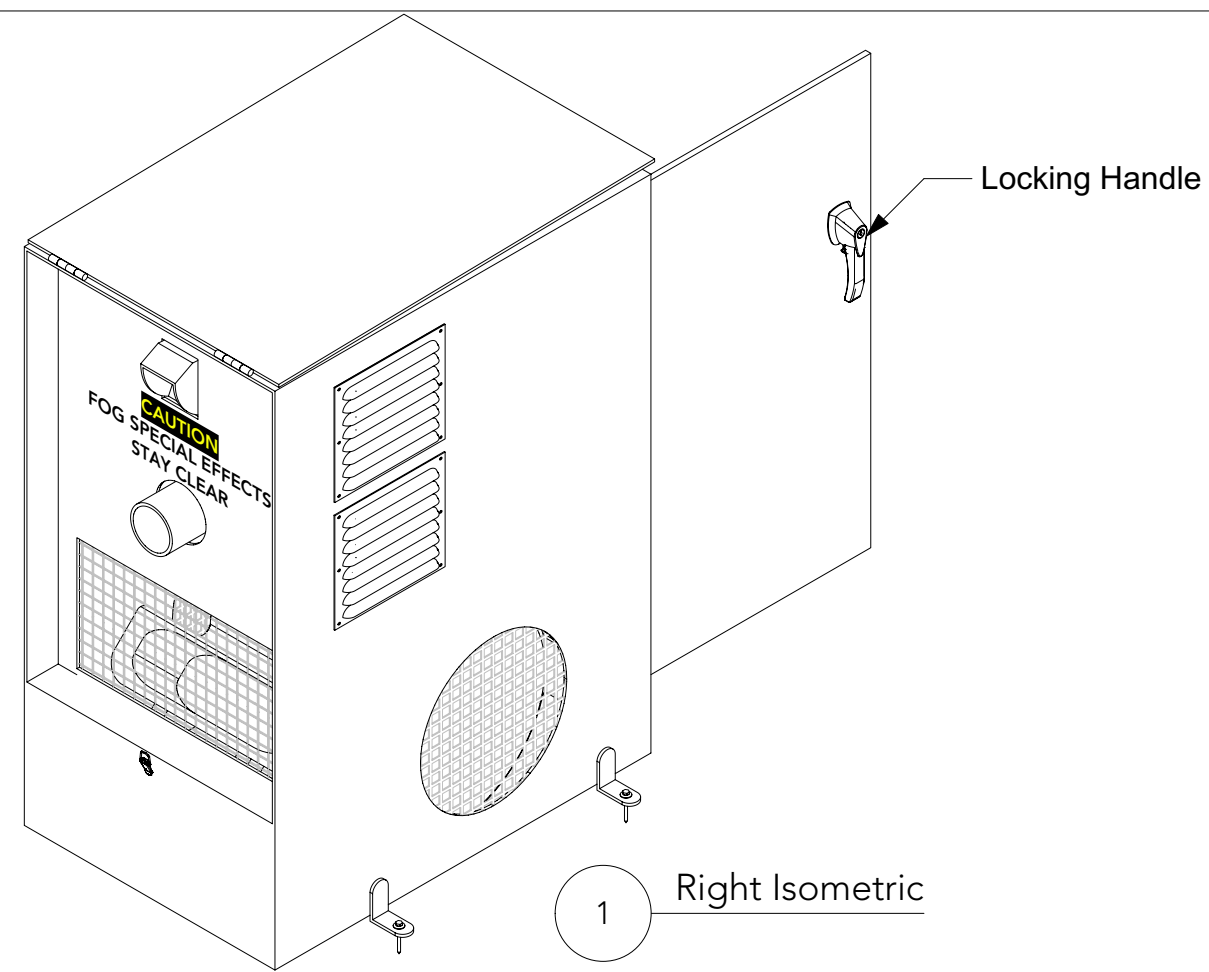

**LOOK SOLUTIONS  
 UNIQUE/VIPER  
 OUTDOOR  
 ENCLOSURE**

VENUE  
MISC.  
LOAD IN  
N/A

This drawing and information contained herein is for general presentation and information review purposes only. This drawing is not intended for use on or in lieu of engineering design plans. This drawing and the information contained therein is the confidential, proprietary information of Cue 13 Design, LLC. and may not be used or reproduced without the approval of Cue 13 Design, LLC.

ISSUE  
4/22/20

DESIGNED BY  
R. STUMPP  
DRAWN BY  
A. LIGHT

**Enclosure Detail**

**FX-1**

**NOTES:**  
 - Enclosure to be powder coated RAL6013  
 - All side vents to have insect screen  
 - Bottom of enclosure to have (6) weep holes  
 - Fog/Hazer output holes approximated and will require shop placement

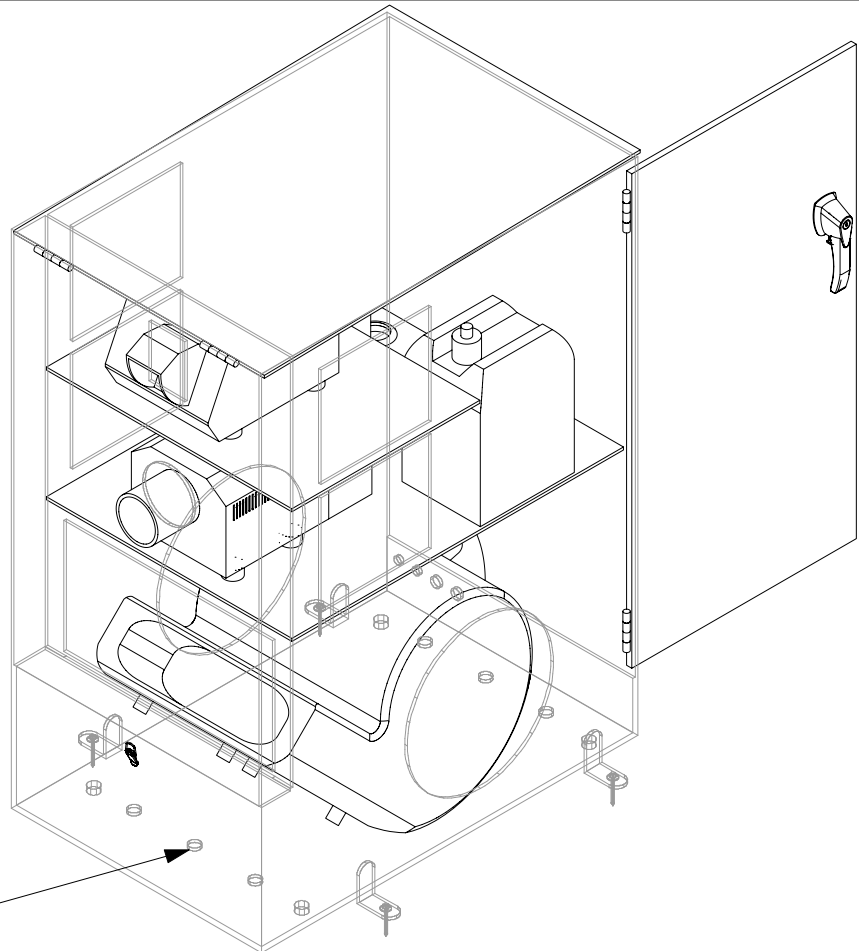

Weep Holes

1 Right Isometric

Look Solutions Unique 2.1 Hazer (27lbs) with Diverter Kit

Look Solutions Viper 2.6 Fogger (27lbs) with 4" Ducting Adapter

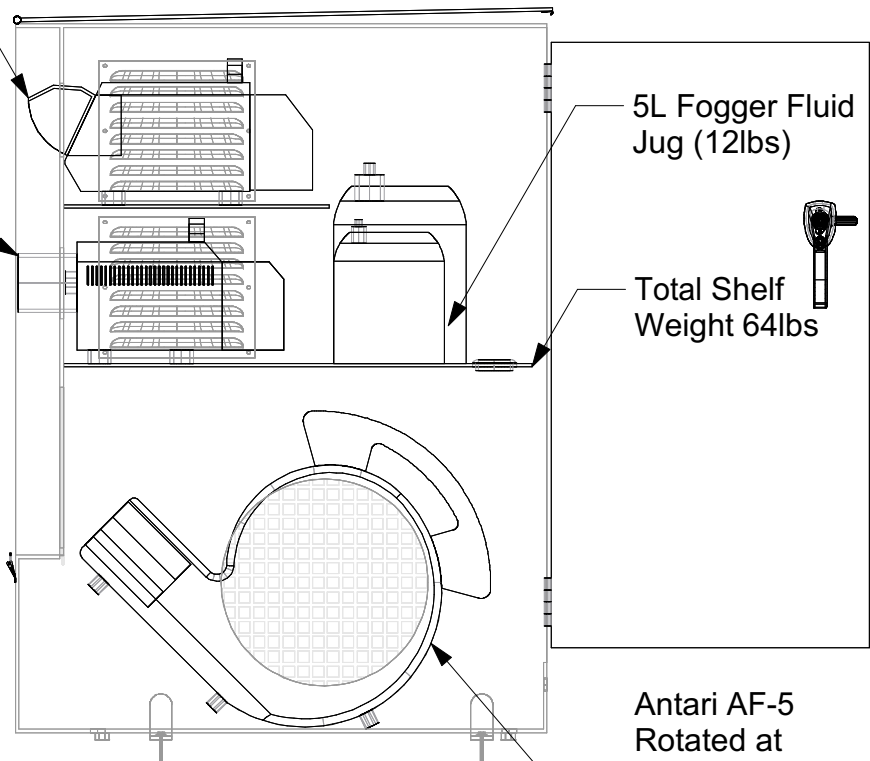

2 Right Elevation

5L Fogger Fluid Jug (12lbs)

Total Shelf Weight 64lbs

Antari AF-5 Rotated at 45-Deg Up Angle

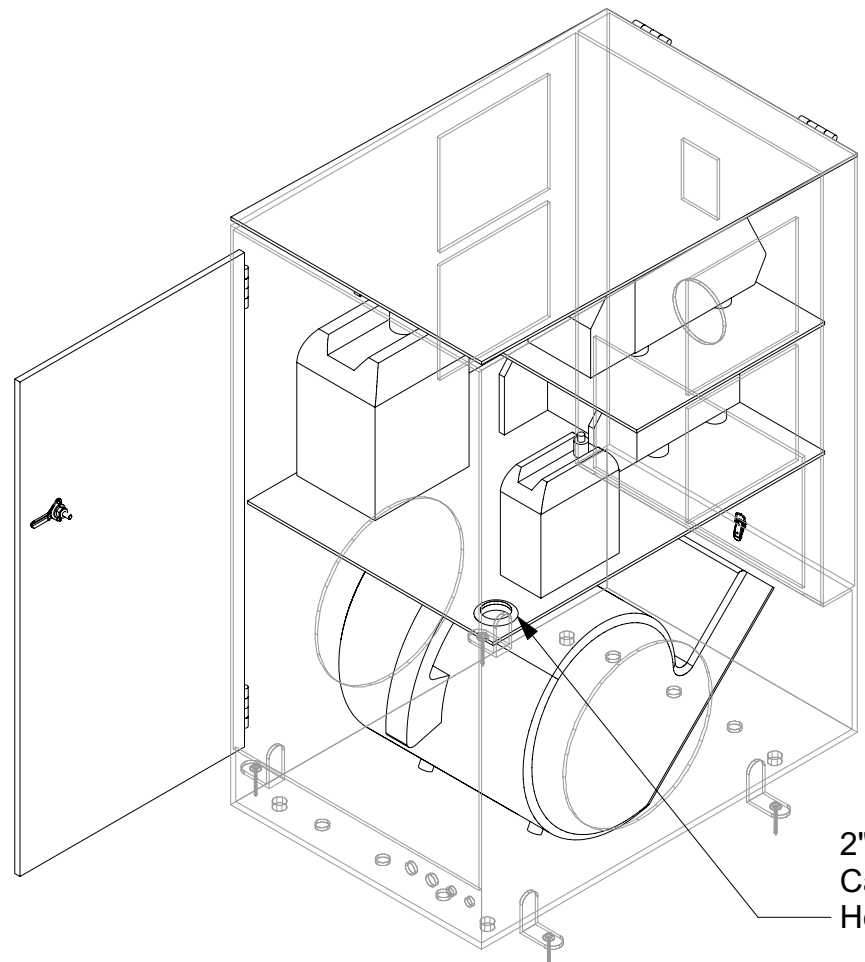

2" Grommeted Cable Chase Hole

3 Left Rear Isometric

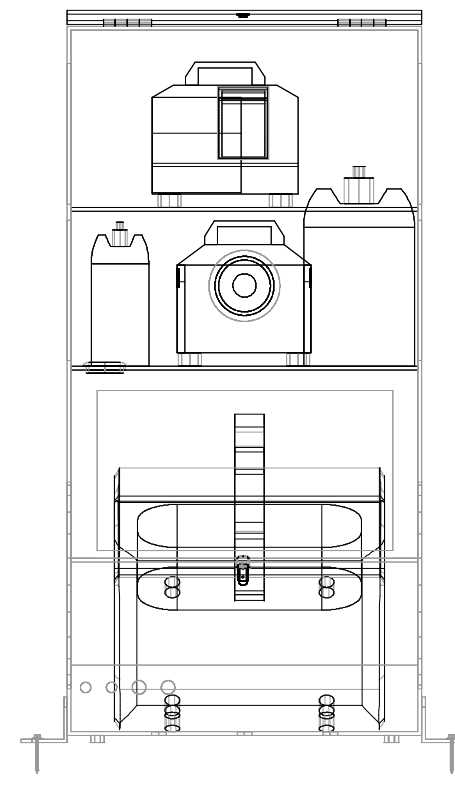

4 Rear Elevation



**LOOK SOLUTIONS  
 UNIQUE/VIPER  
 OUTDOOR  
 ENCLOSURE**

|       |       |         |
|-------|-------|---------|
| VENUE | MISC. | LOAD IN |
|       |       | N/A     |

This drawing and information contained herein is for general presentation and information review purposes only. This drawing is not intended for use on or in lieu of engineering design plans. This drawing and the information contained therein is the confidential, proprietary information of Cue 13 Design, LLC, and may not be used or reproduced without the approval of Cue 13 Design, LLC.

ISSUE 4/22/20

DESIGNED BY R. STUMPP

DRAWN BY A. LIGHT

**Equipment Detail**

**FX-2**

**NOTES:**  
 - Enclosure to be powder coated RAL6013  
 - All side vents to have insect screen  
 - Bottom of enclosure to have (6) weep holes  
 - Fog/Hazer output holes approximated and will require shop placement

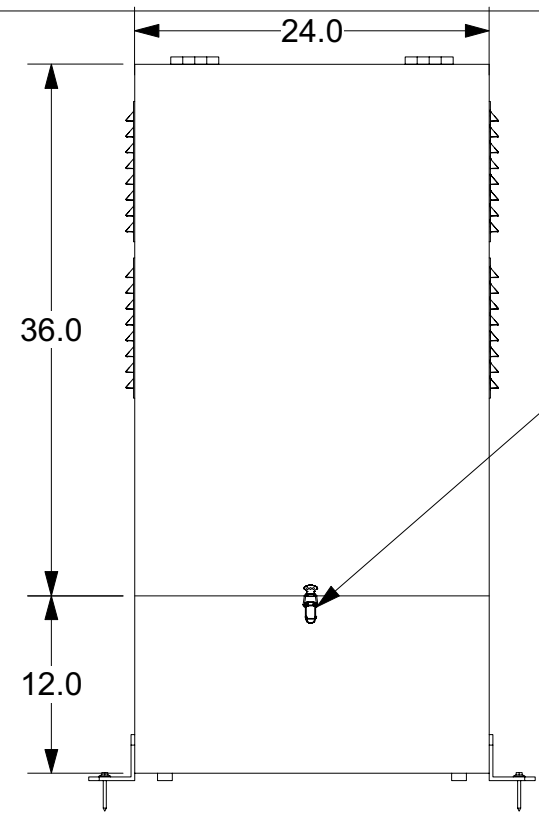

1 Front Elevation  
Door Closed

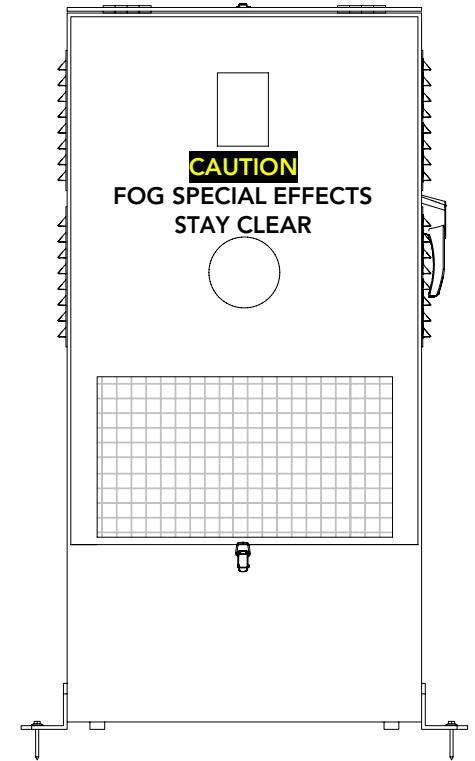

2 Front Elevation  
Door Open

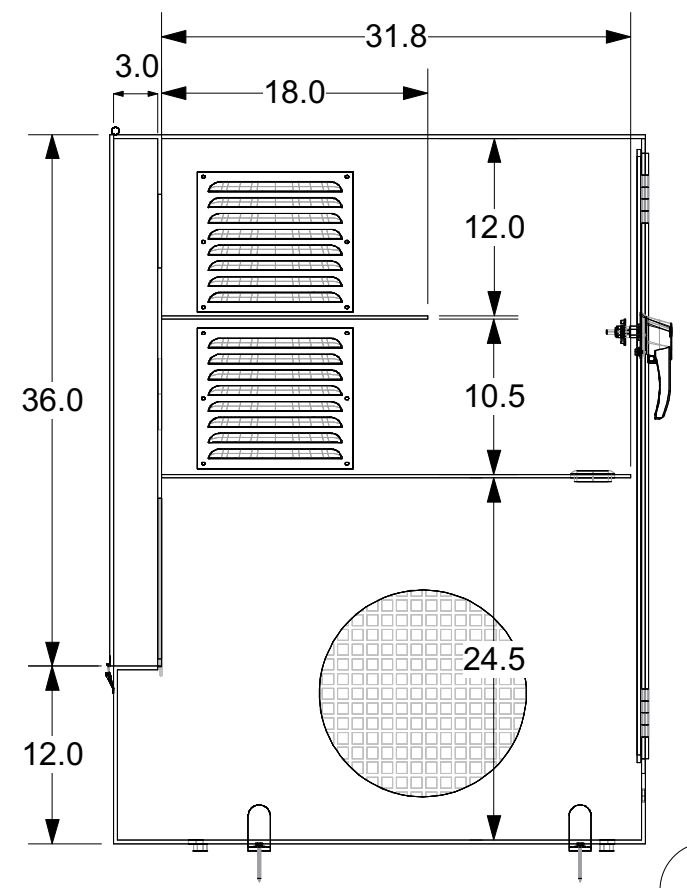

3 Right Elevation  
Door Closed

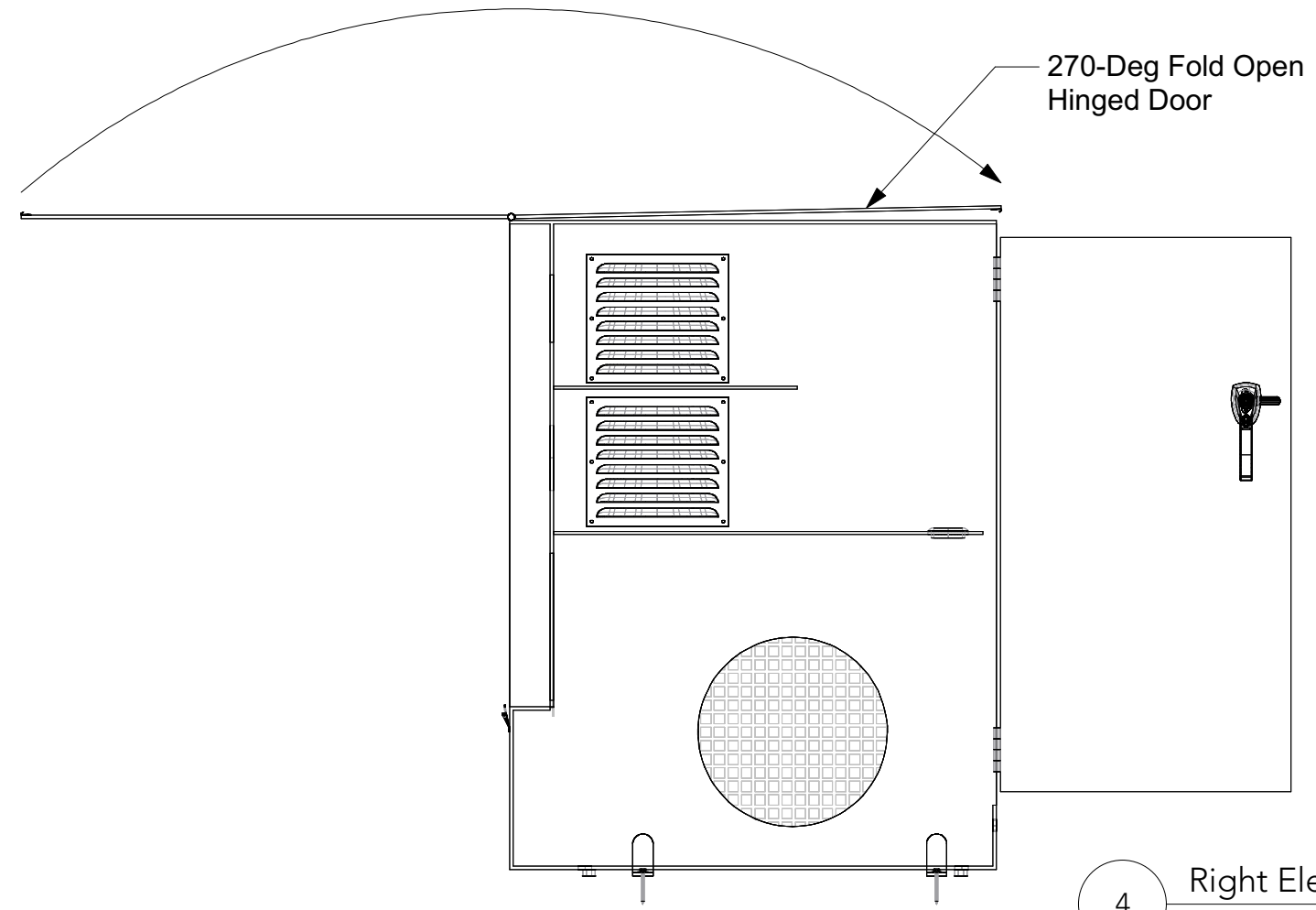

4 Right Elevation  
Door Open



**LOOK SOLUTIONS  
 UNIQUE/VIPER  
 OUTDOOR  
 ENCLOSURE**

VENUE  
MISC.  
LOAD IN  
N/A

This drawing and information contained herein is for general presentation and information review purposes only. This drawing is not intended for use on or in lieu of engineering design plans. This drawing and the information contained therein is the confidential, proprietary information of Cue 13 Design, LLC, and may not be used or reproduced without the approval of Cue 13 Design, LLC.

ISSUE  
4/22/20

DESIGNED BY  
R. STUMPP  
DRAWN BY  
A. LIGHT

**Interior/Door  
Detail**

**FX-3**

**Antari**  
FOG MACHINE  
www.antari.com

*The Wind  
At Your Fingertips*

AF-5, Antari's very first special effects fan.

3 sections fan speeds can satisfy different wind effects requests. It also can work with fog, haze, snow, bubble machines to bring them to higher and farther places. On-board wireless control and DMX make the fan a really versatile model.

- \* Material of Housing: Plastic (Polypropylene)
- \* 3 sections fan speed
- \* Wireless remote included
- \* DMX on-board
- \* Adjustable Wind Angle: Horizontal, 45 degree, Vertical
- \* Power: AC 100~120V , 50/60Hz or AC 220~240V, 50/60Hz
- \* Horsepower: 1 HP
- \* Dimension: 530mm (L) x 470mm (W) x 490mm (H)
- \* Dimension of Vent: 454mm x 153mm
- \* Weight: 17.5 kilogram



ANTARI FAN  
**AF-5**



LOOK SOLUTIONS  
UNIQUE/VIPER  
OUTDOOR  
ENCLOSURE

VENUE  
MISC.

LOAD IN  
N/A

This drawing and information contained herein is for general presentation and information review purposes only. This drawing is not intended for use on or in lieu of engineering design plans. This drawing and the information contained therein is the confidential, proprietary information of Cue 13 Design, LLC, and may not be used or reproduced without the approval of Cue 13 Design, LLC.

ISSUE  
4/22/20

DESIGNED BY  
R. STUMPP

DRAWN BY  
A. LIGHT

**Antari AF-5 Effects  
Fan**

**FX-4**



**UNIQUE<sup>2</sup>**  
[HAZER]



The haze machine **Unique<sup>2</sup>** (follow-up model of the Unique) offers various features, which open up new fields of operation to the user.

Not only the design has been changed, the **Unique<sup>2</sup>** is also equipped with new features like an internal Timer and a brand new Haze-Density Control System (HDCS). With this HDCS an individual profile for a show can be programmed.

Due to the new, more efficient fan, the haze can be distributed in the room quickly. A replaceable filter protects the fan against dirt.

With its variable output, the machine can be used in many fields. Any desired effect can be achieved: from the finest mist to a thick haze, similar to fog. Therefore the machine is able to fill small and big rooms or halls with a constant haze, creating the right atmosphere and excellently supporting lighting effects.

#### Features

- **Minimal warming up time**  
The very short warming up time of approx. 60 seconds means the **Unique<sup>2</sup>** is ready for operation almost immediately.  
A continuous output is guaranteed by the fact that the machine does not have to warm up during operation.
- **Variable output**  
The pump and the fan of the machine can be adjusted separately in 99 steps. Thus the user is able to adjust the density and output exactly.  
A non-linear pump regulation make sure that the pump can be adjusted much better at the lower steps.
- **Minimal sound**  
Due to the fact that the pump and the fan can be dampened, the sound of the **Unique<sup>2</sup>** can be ab-

Manufactured for  
Look – SOLUTIONS MADE IN GERMANY

minimal warm up time

variable output

minimal noise

made in Germany

sorbed tremendously. So the machine can be used in fields of operation where any sound is undesirable and disturbing.

- **Buttons and LED's**  
The control of the pump and fan, the adjusting of the DMX start address and also the adjusting of the Timer and the HDCS is achieved with buttons. The adjusted data can be read at the LED-Display.

- **DMX 512 as standard**  
The **Unique<sup>2</sup>** can be controlled via DMX 512. Pump and fan can be adjusted separately. The connection is done with 5-pin-XLR plugs using two following control channels at the desk.  
The machine can also be controlled with analogue (0-10V) via a lighting desk and via cable remote (option). This connection is done with 3-pin-XLR plugs. A stand-alone running is also possible. The adjustments are done directly at the machine.

- **Internal Timer**  
With the internal Timer the haze time can be exactly adjusted in seconds, the wait time in minutes and the output of pump and fan in %.

- **Haze-Density Control System (HDCS)**  
With the HDCS an individual Profile for a Show can be programmed. Two Levels with the required pump and fan values along with a haze time can be adjusted. Additionally a pre-runtime can be programmed.

- **Minimal fluid consumption**  
A special fluid guarantees minimal fluid consumption, low running costs and an optimal haze effect. It is supplied in 2l-canisters.  
One of these canisters guarantees up to 50 hours of continuous output.

#### Technical Data

|                        |   |
|------------------------|---|
| Procedure              | Haze machine without compressor                                       |
| Power requirement      | 1500 Watt   |
| Voltage                | 230 V/50 Hz or 120V/60 Hz   |
| Warm up time           | approx. 60 sec.   |
| Fluid tank capacity    | 2 Liter   |
| Internal fan           | > 6000 l/min.   |
| Haze density           | adjustable in 99 steps  |
| Control                | DMX 512<br>0 – 10 V analog<br>Stand-alone-Mode<br>XLR-remote (option) |
| Dimensions (L x W x H) | 47 x 25 x 25 cm   |
| Weight without bottle  | approx. 8.7 kg  |

#### Advantages

- Minimal warm up time (approx. 60 sec.)
- Pump and fan adjustable in 99 steps, therefore variable output (from the finest mist to a thick haze, similar to fog)
- Internal fan for quick and homogen distribution
- DMX as standard, analog (0-10V) and stand-alone running
- Control of the pump, fan and the adjusting of the DMX start address is achieved with buttons
- Internal Timer
- Haze-density Control System (HDCS)
- Can be controlled via cable remote (option)
- Very silent
- Minimal fluid consumption (2l canister guarantees up to 50 hours continuous output)
- Made in Germany

#### Dimensions

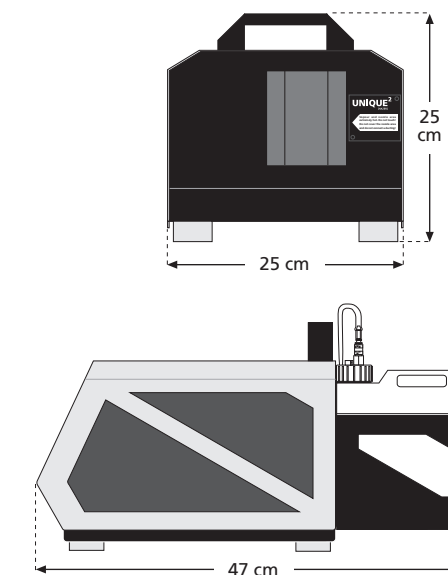

#### Accessories

- Cable remote
- Diverter to divert the direction of the output
- Hanging set  
(Hanging yoke complete with collection tray)
- Case

#### Service

Based on the strong partnership with the German manufacturer OTTEC Technology GmbH, Look Solutions is able to provide a quick and easy service which guarantees the high quality of all products with the motto „innovation by communication“.

www.looksolutions.com



## LOOK SOLUTIONS UNIQUE/VIPER OUTDOOR ENCLOSURE

VENUE  
MISC.

LOAD IN  
N/A

This drawing and information contained herein is for general presentation and information review purposes only. This drawing is not intended for use on or in lieu of engineering design plans. This drawing and the information contained therein is the confidential, proprietary information of Cue 13 Design, LLC, and may not be used or reproduced without the approval of Cue 13 Design, LLC.

ISSUE  
4/22/20

DESIGNED BY  
R. STUMPP

DRAWN BY  
A. LIGHT

## Unique 2.1 Hazer Spec Sheet

# FX-5

# viper 2.6 DMX-FOG GENERATOR

Digital technology and a new design



Manufactured for  
Look – SOLUTIONS MADE IN GERMANY

powerful Output

connector for fan

compact

made in Germany

The **Viper 2.6** is a very powerful fog generator. It unites the current digital technology with proven technik and power.

Very powerful output, simple handling and the possibility to connect an external fan are the main new features of this machine.

## Features

### • Control panel

The control panel with LED-display, simple symbols allow for easy operation. It also protects the control buttons against dirt.

• Finest adjustments of the output  
Digital technology makes fine adjustment of the pump possible. In steps of 1% the output can be adjusted from 0 - 99%. Thus, any desired effect from a tiny fog-cloud to the thickest fog can be produced. This enables the **Viper 2.6** to be used in both small and large locations.

• DMX 512 as standard  
The **Viper 2.6** can be controlled via **DMX 512**. The connection is done with 5pin-XLR-plugs. The DMX start address can be adjusted and saved via the control panel.  
If an external fan is connected to the machine it can be controlled via DMX as well.

The machine can also be controlled with *analog (0 - 10 V)* via a lighting desk or via XLR-remote (option). This connection is done with 3pin-XLR-plugs.

A *stand-alone-mode* is also possible. The adjustments are done directly at the machine. A short press at the start button makes the machine run.

Therefore a permanent pressing of the start button is unnecessary.

• Internal timer  
With the internal timer the fog time can be exactly adjusted in seconds, the wait time in minutes and the output in %.

• Connector for external fan  
An external fan with max. 800 watts can be connected to the **Viper 2.6**.

## Safety

The **Viper 2.6** is equipped with new safety features.

On the front and the back part of the cover there are fixing points for safety bonds.

At both sides of the bottom of the machine are three wholes to which a hanging yoke complete with a collecting tray for fluid drips can be fixed.

## Fluid

The following Look-fog fluids are available for the **Viper 2.6**:

- Quick-Fog (thick, quick disappearing fluid)
- Regular-Fog (thick, long lasting fluid)
- Slow-Fog (thick, extremely long lasting fluid)

## Technical data

|   |   |
|---|---|
| Procedure   | vaporizing fog generator  |
| Power requirement                                     | 2600 Watt   |
| Voltage   | 230V/50Hz   |
| Warm up time  | approx. 7 min.  |
| Fluid consumption at max. output at continuous output | 240 ml/min.<br>70 ml/min.   |
| Fluid tank capacity                                   | 5 liter   |
| Fog output  | adjustable in 99 steps  |
| Output projection                                     | max. 25 m   |
| Fogging time at < 50% output                          | continuous output   |
| external Fan  | max. 800 Watt   |
| Air quantity  | adjustable in 99 steps  |
| Control   | DMX 512<br>0 - 10 V analog<br>Stand-alone-Mode<br>Radio remote (Option) |
| Temperature control                                   | Microprocessor controlled   |
| Overheating protection                                | Heater block/Thermostat<br>Pump/Thermal switch                          |
| Dimensions (L x W x H)                                | 52 x 23 x 25 cm   |
| Weight without bottle                                 | approx. 12 kg   |

## Advantages

- DMX as standard, analog and stand-alone-Mode
- Internal timer
- Easy handling
- Very powerful output
- Fogging output adjustable in steps of 1% from 0 - 99%
- Continuous output
- Connector for external fan with max. 800 Watt
- Easy bottle changing with quick-out connectors
- Made in Germany

## Maße

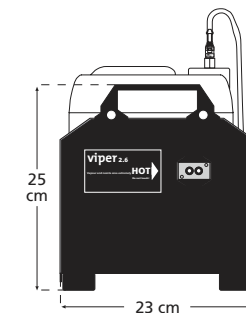
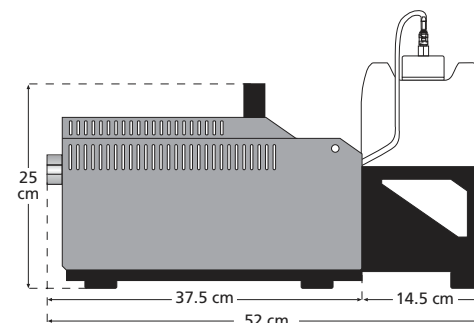

## LOOK SOLUTIONS UNIQUE/VIPER OUTDOOR ENCLOSURE

VENUE  
MISC.

LOAD IN  
N/A

This drawing and information contained herein is for general presentation and information review purposes only. This drawing is not intended for use or in lieu of engineering design plans. This drawing and the information contained therein is the confidential, proprietary information of Cue 13 Design, LLC, and may not be used or reproduced without the approval of Cue 13 Design, LLC.

ISSUE  
4/22/20

DESIGNED BY  
R. STUMPP

DRAWN BY  
A. LIGHT

## Viper 2.6 Spec Sheet

# FX-6

www.looksolutions.com

p.t.o.

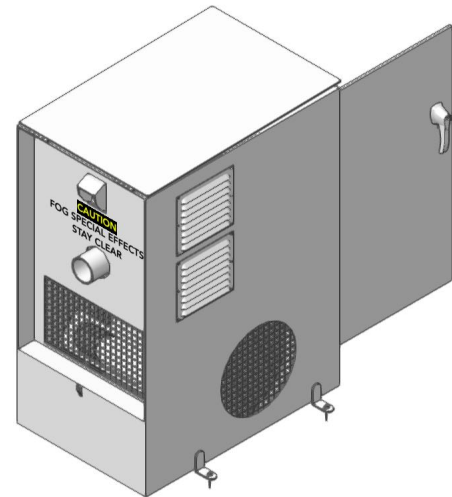
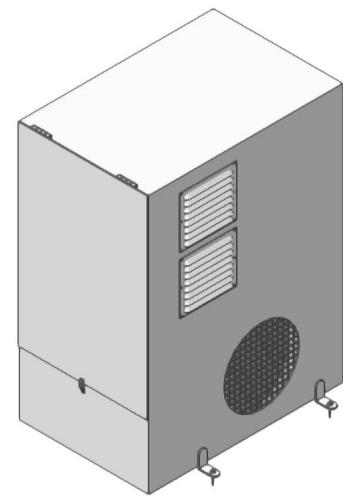

FRONT

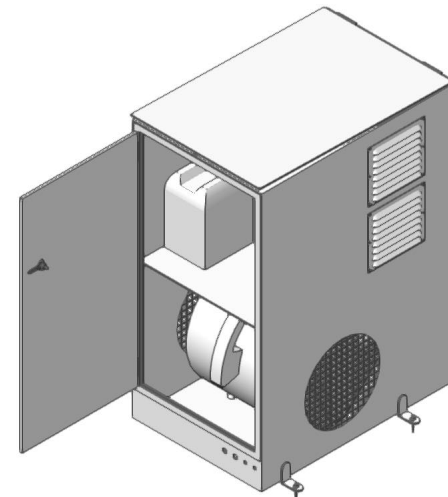
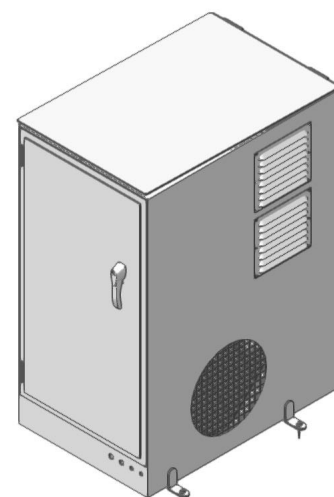

BACK

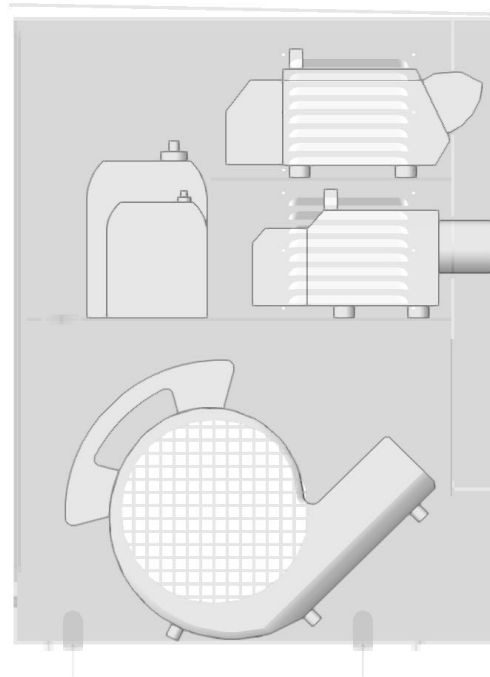

INTERIOR



FINAL PRODUCT



**LOOK SOLUTIONS  
UNIQUE/VIPER  
OUTDOOR  
ENCLOSURE**

VENUE  
MISC.  
LOAD IN  
N/A

This drawing and information contained herein is for general presentation and information review purposes only. This drawing is not intended for use on or in lieu of engineering design plans. This drawing and the information contained therein is the confidential, proprietary information of Cue 13 Design, LLC, and may not be used or reproduced without the approval of Cue 13 Design, LLC.

ISSUE  
4/22/20

DESIGNED BY  
R. STUMPP  
DRAWN BY  
A. LIGHT

**Modeling**

**FX-8**